



MEGA SPLITTER



USER MANUAL

Table of Contents

Safety Information.....	3
Specifications.....	4
Main Power Connection.....	5
DMX-512 Connection.....	5
Installation.....	6
Operation.....	6
Cleaning & Maintenance.....	7
Parts List.....	7

Check that the unit has not been damaged during transport



Read all cautions and warnings
prior to operation of this
equipment

Protection Against Fire



Fire

1. Maintain a minimum of 2 foot distance from any type of flame.
3. Replace fuse only with the specified type and rating.
4. Do Not install the unit to close to a heat source.
5. Make sure cable are properly secured.
6. Maximum surface operating temperature 80°C.

Protection Against Fire



Electrical

1. Disconnect power before servicing.
2. For connection to main power supply proceed to page 5.
3. This unit must be earthed. (electronically grounded)
4. This product is intended for indoor use only.
5. To prevent risk of fire or shock , do not expose fixture to rain or moisture.

Protection Against Mechanical Hazards



Mechanical

1. Use quality clamps or bolts when positioning unit.
2. Do not open unit while it is on, risk of electrical shock.

Specifications

Part Numbers

Fixture

MC1060- Mega Splitter

Mechanical Specifications

- Input DMX Connections:** Front and Rear 3-pin & 5 Pin XLR connectors
- Output DMX Connectors:** 4 output / 3-pin & 5 Pin XLR connectors
- Power Connection:** IEC power connection to Edison
- Fastening System:** 1U Rack Mountable Front or Back & wall mountable

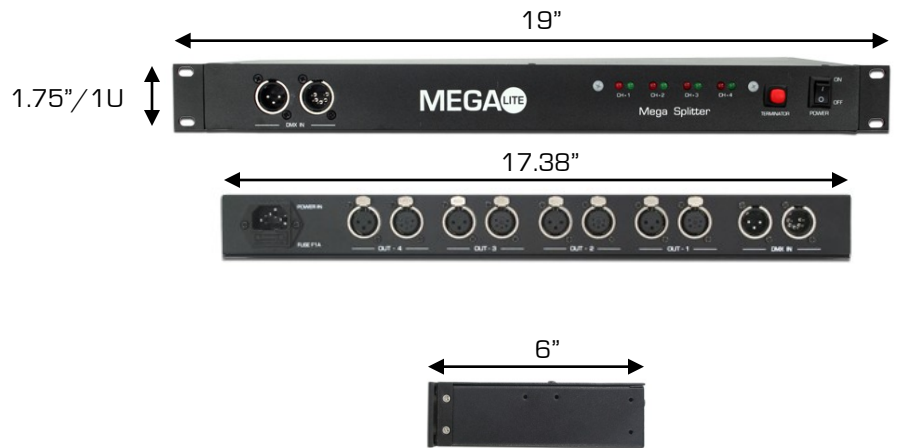

Fixture	Packaged for Shipping
Size: 19" x 1.75" x 6"	Size: 20" x 7.5" x 3"
Weight: 5 lb	Weight: 6 lbs

Electrical Specifications

- Electronic isolation between input & output
- Electronic isolation between output and output
- Terminator button for last unit
- Power indicator
- Signal indicator
- Power Consumption: 110V-60 Hz

Main Power Connection

Caution!

1. Do not connect fixture to a dimmer system.
2. This unit must be earthed. (electronically grounded)
3. Replace fuse only with the specified type and rating.

The occupation of the connection-cable is as follows:

110V Connection

Cable (USA)	Cable (EU)	Pin	Connection
Black	Brown	Live	L
White	Light Blue	Neutral	N
Green	Yellow/Green	Ground	

DMX-512 Connection

The Mega Splitter is a DMX signal amplifier and distributor. The unit allows you to split a DMX signal into four separate signal outputs. Also it boost your DMX signal for extensive cable runs between DMX lighting fixtures

DMX—input

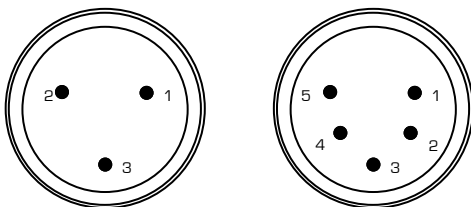

1. Shield
2. Signal (-)
3. Signal (+)
4. Not Used
5. Not Used

DMX—output

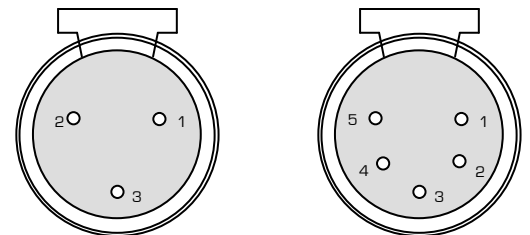

Installation

The Mega Splitter can be rack mounted from the front or back or wall mounted. For wall mount, remove the rack ears on the front panel and screw them on the side panels. For rear mounting remove the rack ears from the front and mount them on the rear panels

Rack Mount



Wall Mount



Operation

1. Connect DMX out from your DMX controller (you can use either the 3 or 5 Pin XLR connection) to your DMX in of the Mega Splitter You can use the Input from the front or the rear.

Any DMX Controller



2. Use the four output channels to send DMX signal to your DMX fixture. (You can use either the 3 or 5 pin XLR connection).

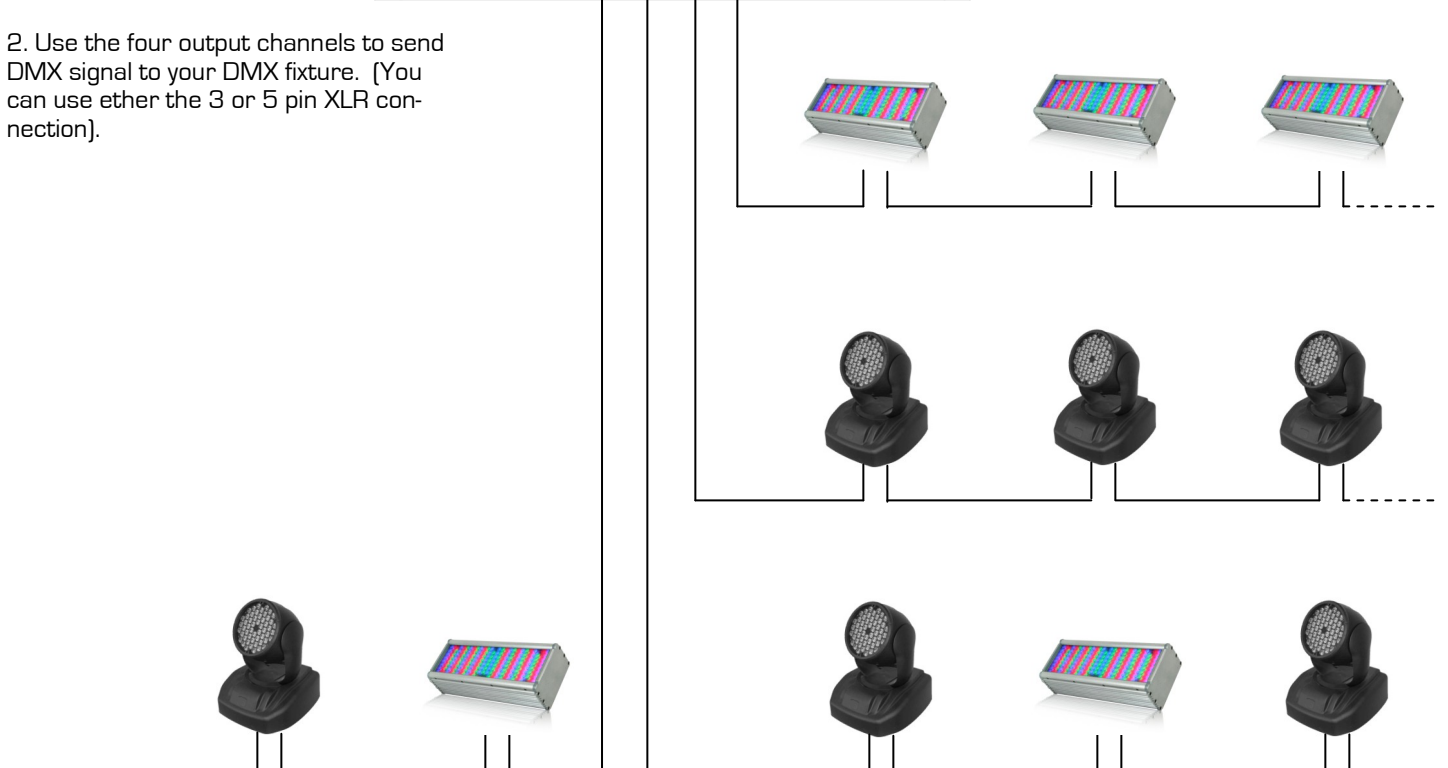

Cleaning and maintenance

Installation Maintenance: The operator has to make sure that the unit is operating safely and has the installations and electronics checked by an expert every 2 years.

The following points have to be considered during the inspection:

- 1) All screws used for installing the device or part of the device have to be tightly connected and must not be corroded.
- 2) There must not be any deformations on the housing, fixation and installation spots (ceiling, suspension, trussing).
- 3) The power supply cables must not show any damages, material fatigue (e.g. porous cables) or sediments. Further instructions depending on the installation spot and usage have to be adhered by a skilled installer and any safety problems have to be removed.

Caution Danger to life!



Electrical

Disconnect from mains before starting maintenance operation!

Note: There is no serviceable parts inside the device except for the LED's. Maintenance and service operations are to be carried out by authorized dealers.

Replacing the fuse: Only replace the fuse with the same type and rating.

Replacing the power cable: If the power cable of this device becomes damaged, it has to be replaced by authorized dealers only in order to avoid hazards.

Should you have further questions , please contact your dealer.

Parts List

MC1060-mpcb	Main PCB Card
MC1060-ts	Terminator Switch
MC1060-ps	Power Switch
MC1060-pc	Power Connection
MC1060-xlr3m	3 Pin XLR Male
MC1060-xlr3f	3 Pin XLR Female
MC1060-xlr5m	5 Pin XLR Male
MC1060-xlr5f	5 Pin XLR Female



Mega-Lite
18668 Hwy 16 N.,
Helotes, TX 78023
Ph 210-684-2600 Fax 210-855-6279
www.mega-lite.com / info@mega-lite.com