



PRO BAR 4



User Instructions

Elation Professional®
4295 Charter Street
Los Angeles CA. 90058
www.elationlighting.com

Contents

Features 1

General Instructions 2

- 1. Overview 3
- 2. Operation Guide 5
 - 2.1 Mode Select 5
 - 2.2 DMX Mode 5
 - 2.3 MIDI Mode 6
 - 2.4 Master Mode 7
 - 2.5 Preset Functions 8
 - 2.6 Chase Direction 10
 - 2.7 Cross and Normal Dimmer 10
 - 2.8 Link Up 11
 - 2.9 Initialization 11

Technical Specifications 12

Improvement and changes to specifications, design and this manual, may be made at any time without prior notice.

All rights reserved.

Features

***Thank you for your purchase.
This product features include:***

- 4 channel chaser with 16 built-in programs and 6 operating modes: MANUAL DIMMER/MANUAL PROGRAM/AUTO PROGRAM/HOLD SOUND/ PROG. SOUND/ AUTO SOUND.
- 4 channel MIDI pack with 4 individual Note Numbers
- 4 channel DMX dimmer pack with 4 individual DMX addresses
- Normal/Cross dimmer
- Forward/Reverse chasing direction
- Fade Time control
- Preheat function
- Manual override
- Built-in microphone for Music triggering
- Power failure memory

General Instructions

Read the instruction in this manual carefully and thoroughly, as they give important information regarding safety during use and maintenance. Keep this manual with the unit, in order to consult it in the future. If the unit is sold or given to another operator, make certain that it always has its manual, to enable the new owner to read about its operation and relative instructions.

WARNING

- This product must be earthed.
- **DO NOT** make any inflammable liquids, water or metal objects enter the unit.
- To prevent fire or shock hazard, do not expose this product under a high temperature or humidity area.
- Take care not to damage the power cord.
- **DO NOT** open the unit--there are no user serviceable parts inside.
- **NEVER** try to repair the unit yourself. Repairs by unqualified people could cause damage or faulty operation. Contact your nearest dealer.
- Wait for at least one second to turn on the power after turning off this unit.

CAUTION

- This unit is intended for indoor use only.
- After having removed the packaging check that the unit is **NOT** damaged in any way. If in doubt, **DON'T** use it and contact an authorized dealer.
- Packaging material (plastic bags, polystyrene foam, nails, etc.) **MUST NOT** be left within children's reach, as it can be dangerous.
- **STOP** using the unit immediately in the event of serious operation problems and either contact your local dealer for a check or contact us directly.
- **DO NOT** dismantle or modify the unit.

1. Overview

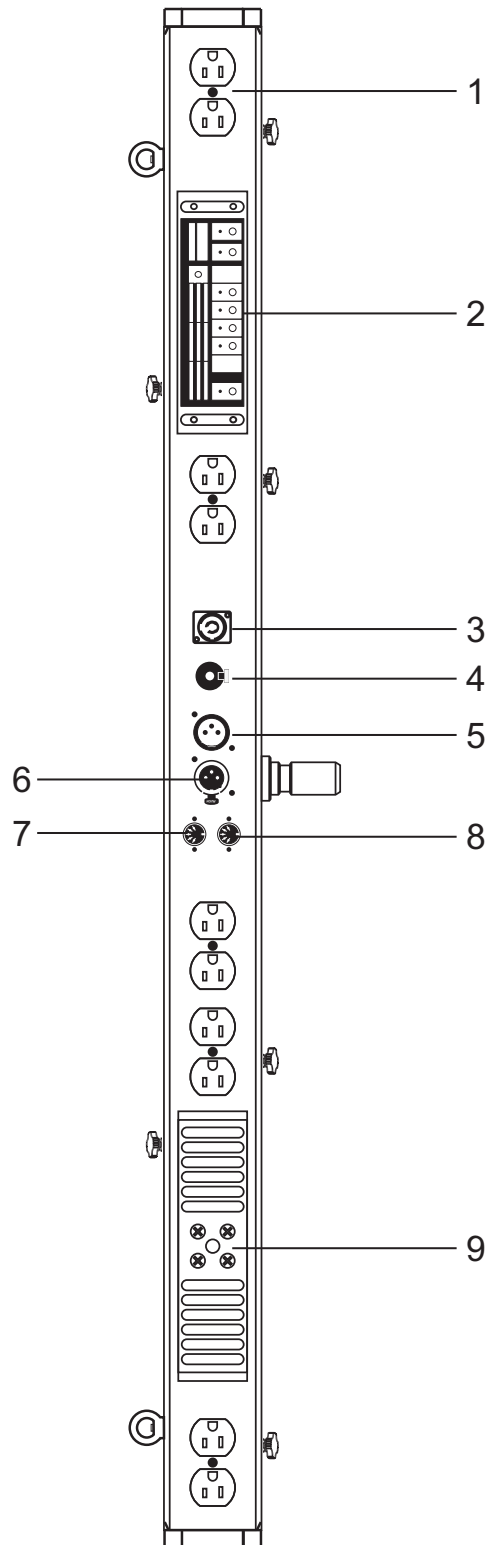

1. Overview

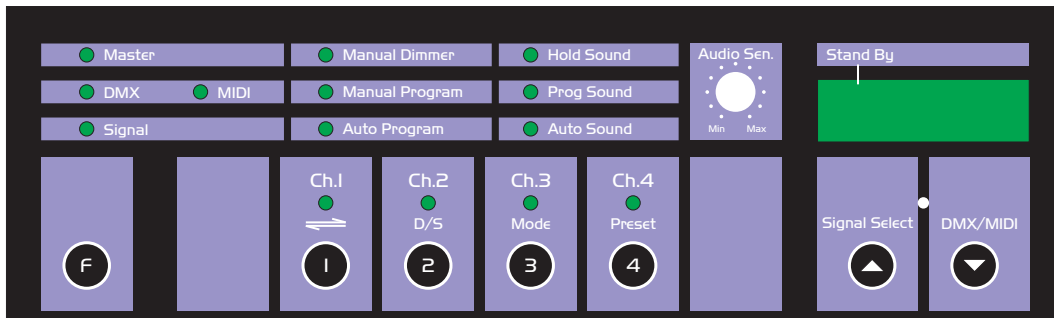

Control Board

- | | |
|----------------------------------|---|
| 1. Channel Output | 10 A/CH., Total 20 A max. |
| 2. Control Board | This control board is used to set this unit via these function buttons. |
| 3. Power Input | NAC3MPA by Powercon, 250V, 20A |
| 4. Foot control connector | 1/4 inch stereo phone jack |
| 5. DMX IN | This connector receives DMX signal. |
| 6. DMX Out | This connector sends DMX signal. |
| 7. MIDI IN | This connector receives MIDI signal. |
| 8. MIDI THRU | This connector sends MIDI signal through to the next MIDI device. |
| 9. Channel Fuse | F10A 250V 5x20mm |

2. Operation Guide

2.1 Mode Select

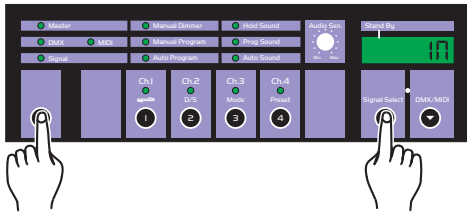

Press and hold down F button first, tap the Signal Select button, the Segment Display shows "IN".

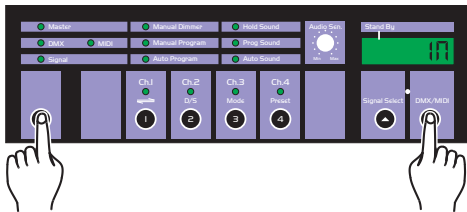

Keep pressing F button, tap the DMX /MIDI button to select DMX or MIDI mode, corresponding LED indicates the current mode.

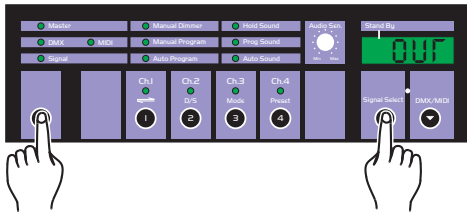

While holding down F button, tap Signal Select button, when the Segment Display shows "OUT", Master LED lights indicating Master mode is active.

2.2 DMX Mode

When the Segment Display shows "IN" and the DMX LED lights, this unit serves as a 4 channel DMX dimmer pack. The Signal LED blinks when DMX signal is available.

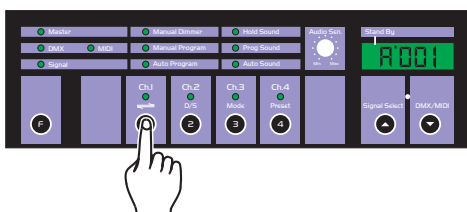

1. Tap the channel button(Ch1-Ch4), the corresponding channel LED blinks indicating your selection and the Segment Display shows the DMX address of the channel.

2. Operation Guide

2.2 DMX Mode

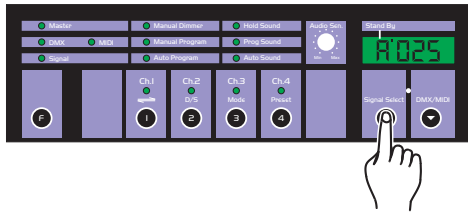

2. Tap the Up/Down button to select your desired DMX address from 001 to 512.

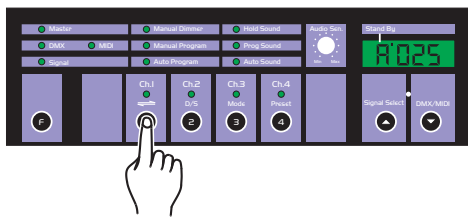

3. Once you've set the DMX address, tap the channel button a second time to store your setting into memory.

4. Continue steps 1-3 until you've set the addresses all 4 channels.

2.3 MIDI Mode

When the Segment Display shows "IN" , while holding down F button, tap DMX /MIDI button causing the MIDI LED lights up, which indicates MIDI mode is active. The Signal LED blinks when MIDI signal is available.

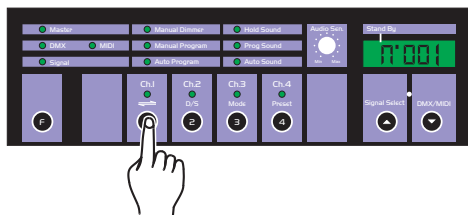

1. Tap the channel button(Ch1-Ch4), the corresponding channel LED blinks indicating your selection and the Segment Display shows the Note Number of the channel.

2. Operation Guide

2.3 MIDI Mode

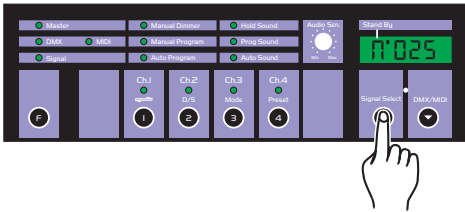

2. Tap the Up/Down button to select the Note Number from 001 to 128.

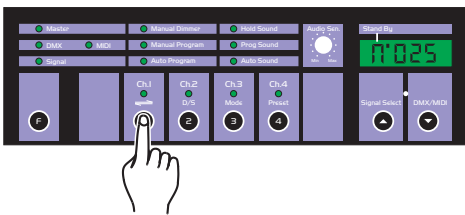

3. Once you've selected the Note Number, tap the channel button a second time to store your setting into memory.
4. Continue steps 1-3 to set Note Number of the other channel.

2.4 Master Mode

When the Segment Display shows "OUT" and the Master LED lights, this unit serves as a 4 channel DMX chaser.

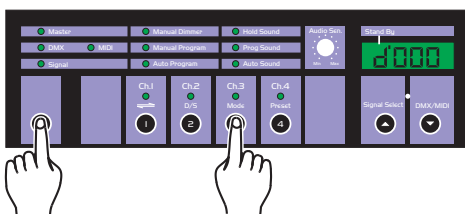

Keep pressing F button, tap Mode button several times to select chase mode from Manual Dimmer/ Manual Program/Auto Program/Auto Sound/Prog. Sound/Hold Sound, corresponding LED indicates your selection.

2. Operation Guide

2.4 Master Mode

Manual Dimmer	Manual Dimmer LED is on, you can adjust the intensity of individual of 4 channels using CH 1-4 and UP/DOWN buttons.
Manual Program	Manual Program LED is on, you can select any of 16 preset programs to chase.
Auto Program	Auto Program LED is on, every of 16 programs will be executed 8 times in sequence.
Hold Sound	Hold Sound LED is on, channels 1-4 are controlled by music rhythms detected by built-in microphone, its sensitivity can be adjusted.
Prog Sound	Prog Sound LED is on, the programs are executed by Bass, 16 preset programs are selectable.
Auto Sound	Auto Sound LED is on, every of 16 programs will be

2.5 Preset Functions

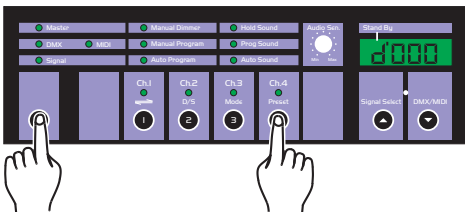

Keep pressing F button, tap Preset button several times to change functions between Fade Time/Dimmer/Preheat/Speed/Program /MIDI channel.

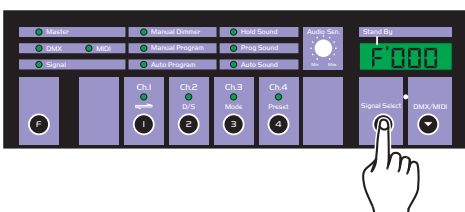

Fade Time

The Segment Display shows "F" followed by three numbers 000-100. Tap Up/Down button to set fade time from instant to 60 seconds.

2. Operation Guide

2.5 Preset Functions

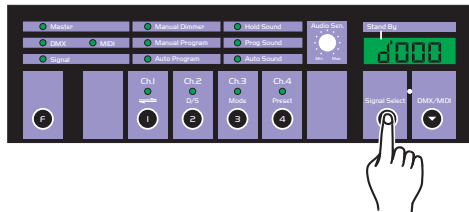

Master Dimmer
or
Channel Dimmer

The Segment Display shows "d" followed by three numbers 000-100. Tap Up/Down button to adjust intensity from fully off(000) to fully on(100).

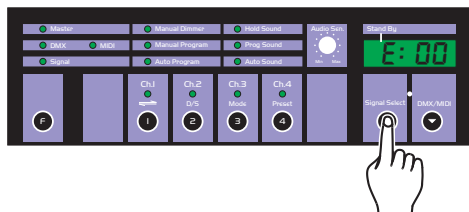

Preheat

The Segment Display shows "E" followed by two numbers 00-25. Tap Up/Down button to adjust from 0% intensity to 25% intensity.

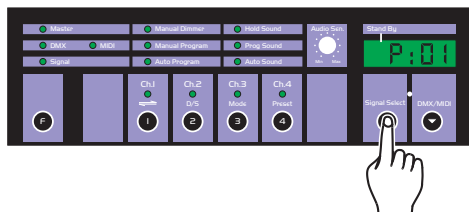

Program

The Segment Display shows "P" followed by two numbers 01-16. Tap Up/Down button to select desired chase program.

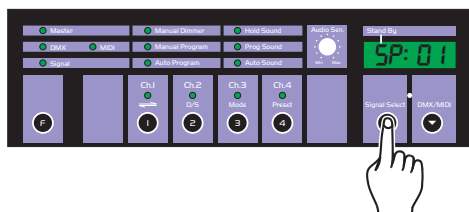

Speed

The Segment Display shows "SP" followed by two numbers 01-99. Tap Up/Down button to select desired chase speed. 01 will give a slowest speed, 99 will give a fastest speed.

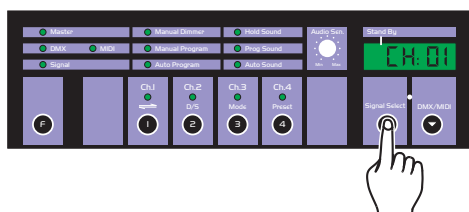

MIDI Channel

The Segment Display shows "CH" followed by two numbers 01-16. Tap Up/Down button to select your desired MIDI Channel.

2. Operation Guide

2.6 Chase Direction

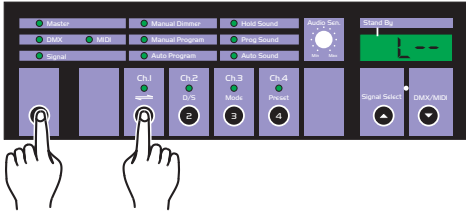

Keep pressing F button, tap \Rightarrow button to select chase direction, the Segment Display shows "L--" or "R--". "L--" indicates the programs will chase from left to right, and "R--" indicates the programs will chase from right to left.

2.7 Cross and Normal Dimmer

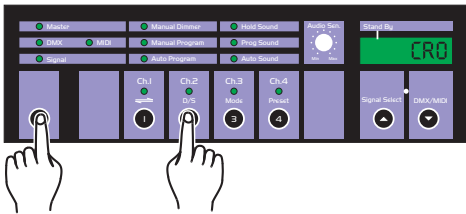

Keep pressing F button, tap D/S button to select dimmer mode from Cross / Normal dimmer.

The Segment Display shows "CRO" when cross dimmer is active. In Cross mode, if channel intensity is 50%(>50%) , the fixture will be fully on; if channel intensity is less than 50%, the fixture will be fully off.

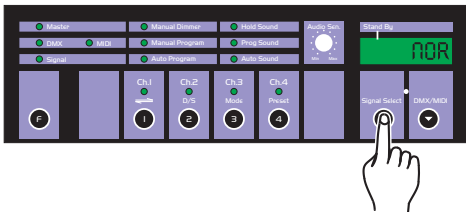

The Segment Display shows "NOR" when normal dimmer is active. In Normal mode, you can adjust the intensity using UP/DOWN button.

2. Operation Guide

2.8 Link Up

Several units can be linked up using DMX cables. When linking, make sure only one unit works in Master mode, and the other units will work depending on the master unit.

2.9 Initialization

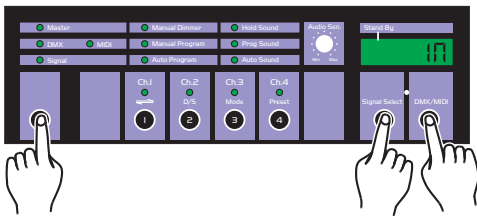

Press F, Signal Select and DMX/ MIDI buttons at a time, this unit will initialize its memory, the Segment Display goes out. Release all three buttons, this unit will return to default setting, the Segment Display shows "IN", and Manual Dimmer LED is on.

3. Technical Specifications

Power Input	AC 120V~50-60Hz
Channel Output	10A/CH., Total 20A
DMX In/Out	3 pin female & male XLR socket x1
MIDI In/Thru	5 pin multiple socket
Channel Fuse	F10A 250V 5x20mm (x4PCS)
Dimensions	1320x60x80mm
Weight(approx)	4.3 kg



Elation Professional ®
A Division of the American DJ Group of Companies
4295 Charter Street Los Angeles, CA 90058 USA
Tel: 323-582-3322 Fax: 323-582-3311
Web: www.elationlighting.com
E-mail: info@elationlighting.com

24-004-1529
Rev1.1